



Rakvere

A. Puškini

A. J. Jhanovi



51101.003.0051

51101.003.0040

51101.001.0954

51101.003.0092

51101.003.0066

51101.003.0066

51101.003.0052

51101.001.1190

51101.001.1190

51101.003.0013

51101.003.0012

51101.001.0362

51101.003.0014

51101.003.0015

51101.003.0042

51101.003.0088

51101.001.1900

51104.004.0008

51104.004.0059

51104.004.01673

51104.004.0009

51104.004.0217

51104.004.0068

51101.001.1376

51101.001.0175

51101.001.0234

51104.004.0132

51104.004.0042

51101.003.0087

51101.001.1049

51101.001.1048

51101.003.0089

51101.004.0131

51101.004.0072

51101.004.0002

51101.001.0937

3

3

3

3

3

39/2

39/1

18

20

20a

20b

20c

81

3

3

3

3

3

51101:003:0051

Rokvere tn 22d

Tenniseväljakute konstruksiooniline lahendus, sh
drenaazi ja sajuvee lahendus, antakse eraldi projektiga

51101:003:0013

Rokvere tn 20b

32
x=6590450.22
y=738211.78

37
x=6590430.92
y=738178.54

39
x=6590427.22
y=738108.48

38
x=6590407.29
y=738116.07

2

23

5

8

10

6

9

1

51101:003:0065
Rokvere tn 22f

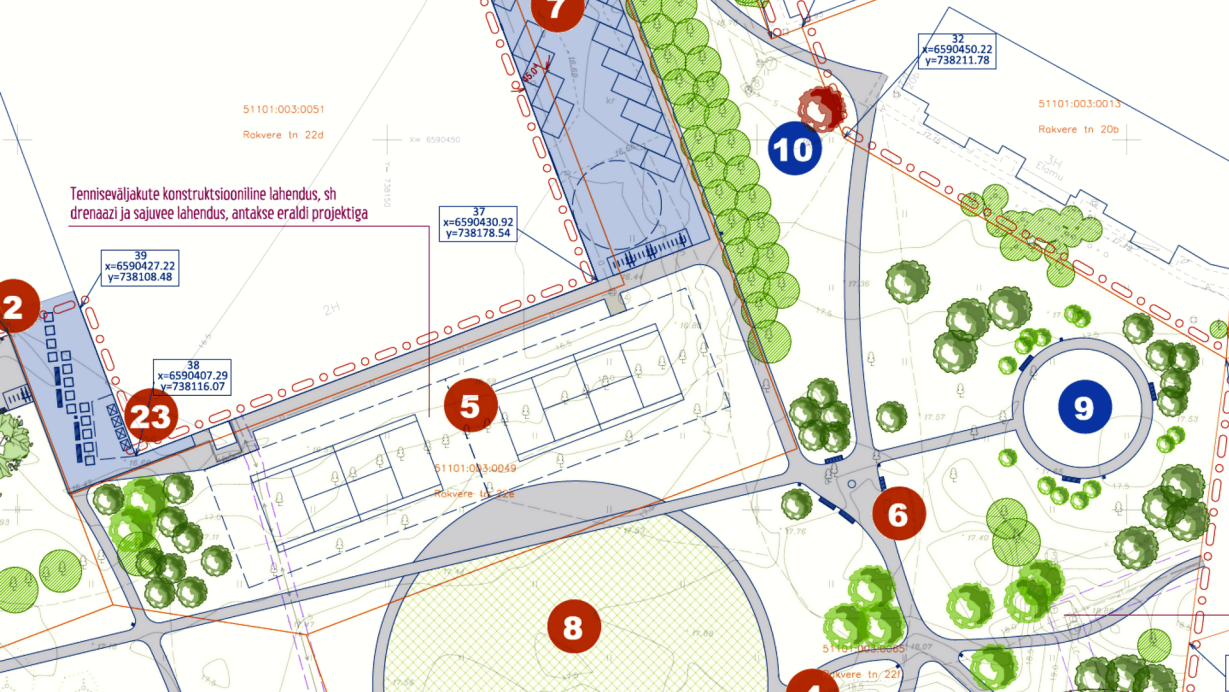

PUŠKINI TN

RAKVERE TN

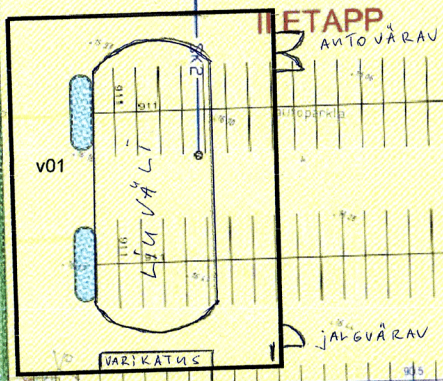

EVS 100 PARK

SPORDI HOONE

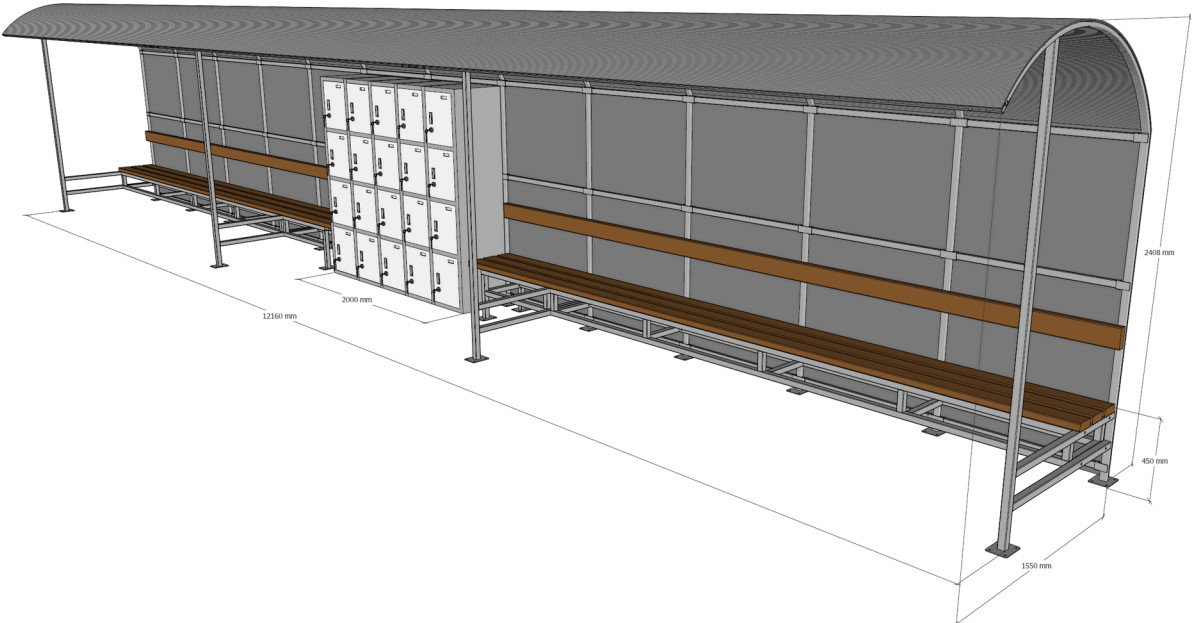

12160 mm

2000 mm

2408 mm

450 mm

1550 mm